

USER MANUAL

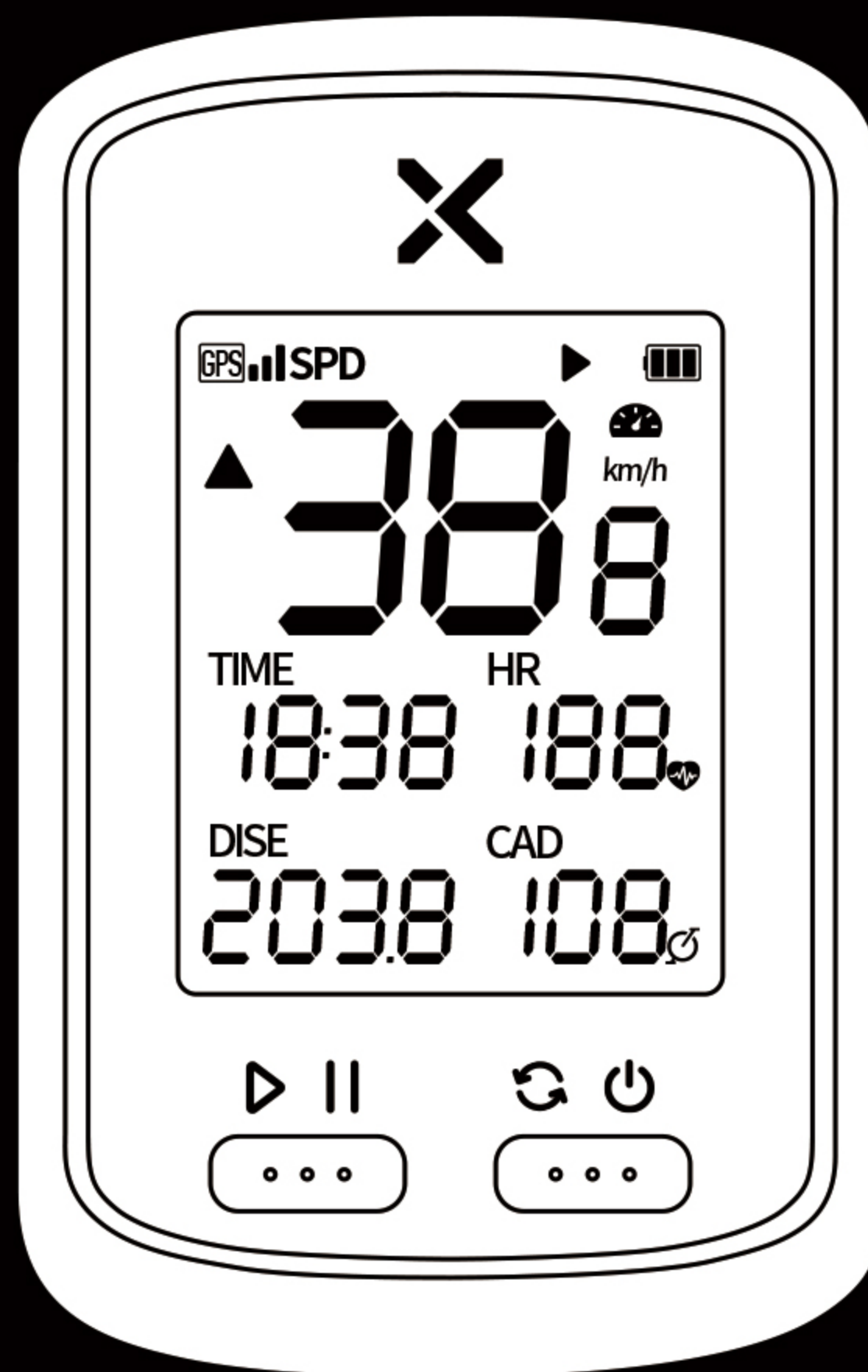

XOSS G+
GPS CYCLING COMPUTER

GPS LOCATION – QUICK START GUIDE

To receive satellite signals, please remains static and make sure your device is used at open space and barrier-free area.

- 1** LONG PRESS THE RIGHT BUTTON TO TURN ON.

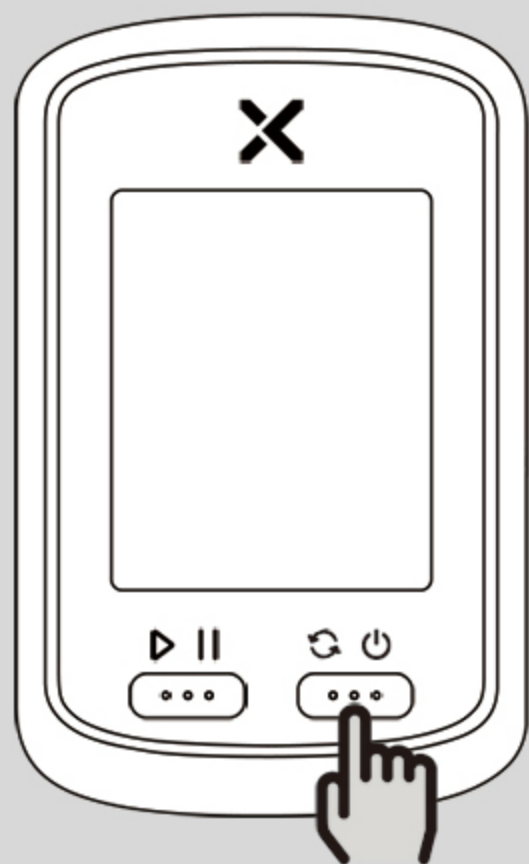

- 2** PRESS THE LEFT BUTTON TO ACTIVATE GPS.

GPS icon flashes when getting ready

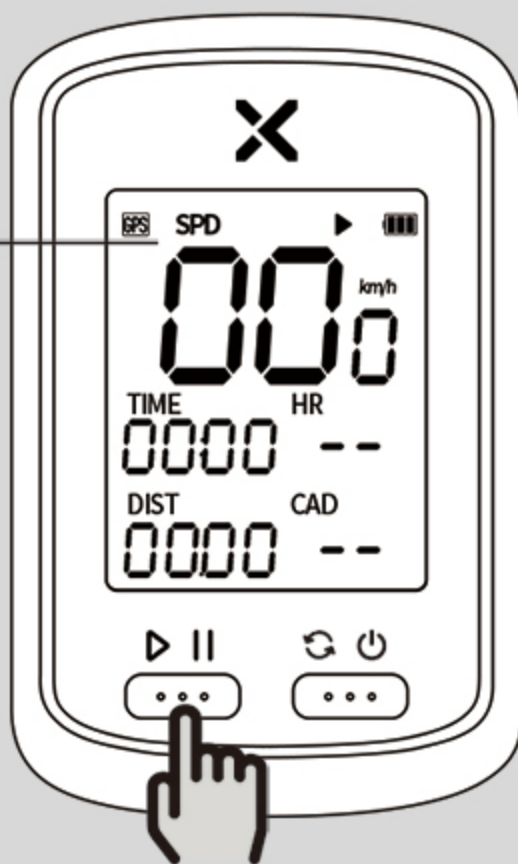

- 3** GET GPS SIGNAL AFTER START UP TAKES A FEW MINUTES.

 appears solid with BEEP prompt to indicate the device is ready.



- 4** ENJOY YOUR RIDE.



1.INTRODUCTION

SPECIFICATIONS

NAME	XOSS G+ GPS Cycling Computer
SIZE	48*75*19mm
PRODUCT WEIGHT	52g
OPERATING TEMPERATURE	-10~50℃
BATTERY	500mAh Rechargeable Lithium Ion
RECORDING TIME	Up to 25 Hours
WATERPROOF	IPX7
DATA	GPS SPD TIME HR CAD DIST GRD ALT CLOCK ODO
ANT+ SENSOR SUPPORT	Speed Sensor, Cadence Sensor,Heart Rate Monitor, Speed/Cadence Sensor.

START/PAUSE RECORDING

Press the Left Button

RESUME/PAUSE

Press the Left Button

END RECORDING

Long press the left button

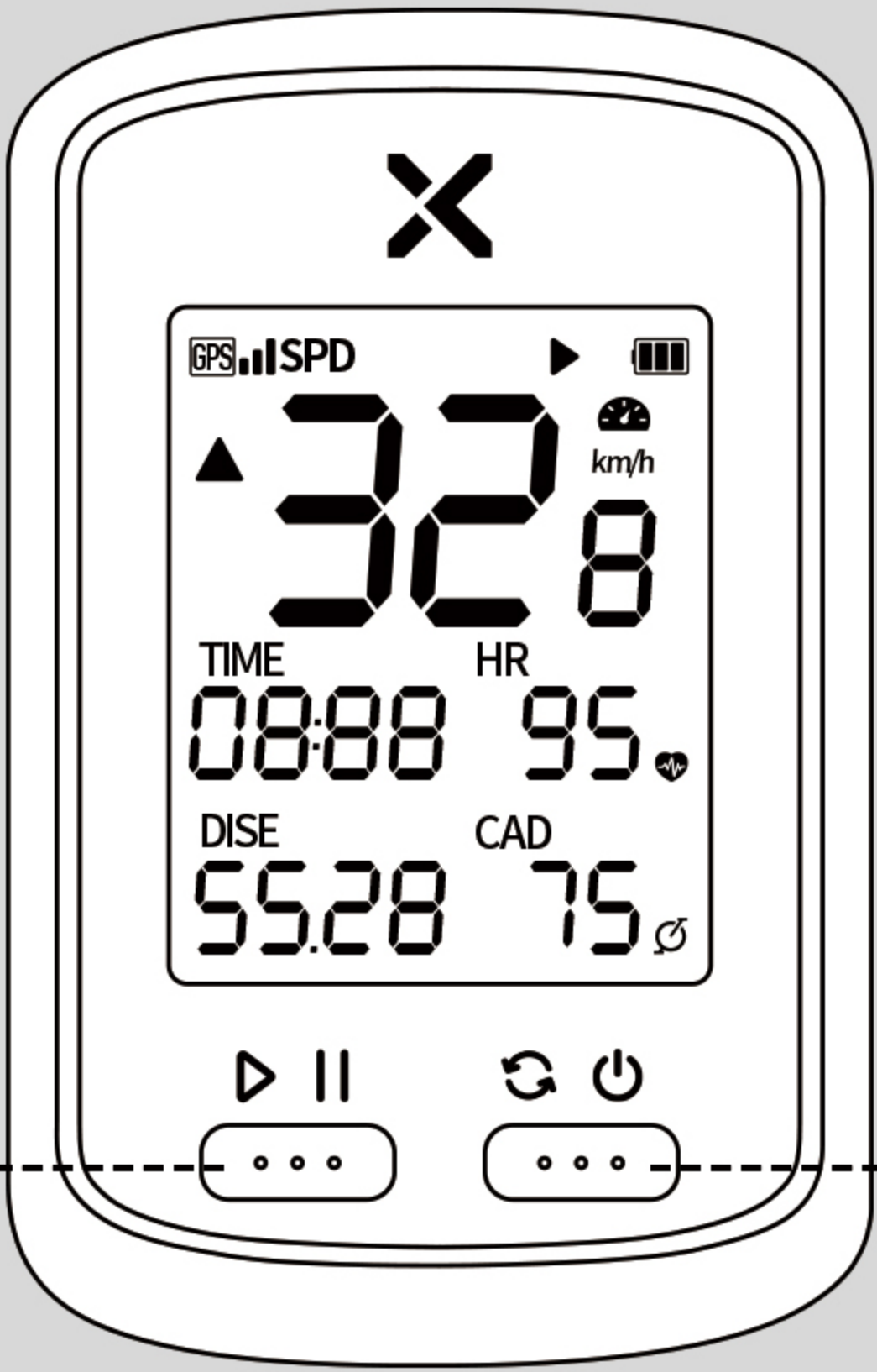

1 POWER ON/OFF

Long press the right button

2 SWITCH DATA DISPLAY

Press the right button

RECORD 15 TYPES of DATA

SPD (CURRENT SPEED)	HR (CURRENT HEART RATE)	CAD (CURRENT CADENCE)	TIME (TIME)	DIST (DISTANCE)
AVG (AVERAGE SPEED)	AVG (AVERAGE HEART RATE)	AVG (AVERAGE CADENCE)	ALT (ALTITUDE)	GRD (GRADE)
MAX (MAX SPEED)	MAX (MAX HEART RATE)	MAX (MAX CADENCE)	CLOCK (CLOCK)	ODO (ODOMETER)

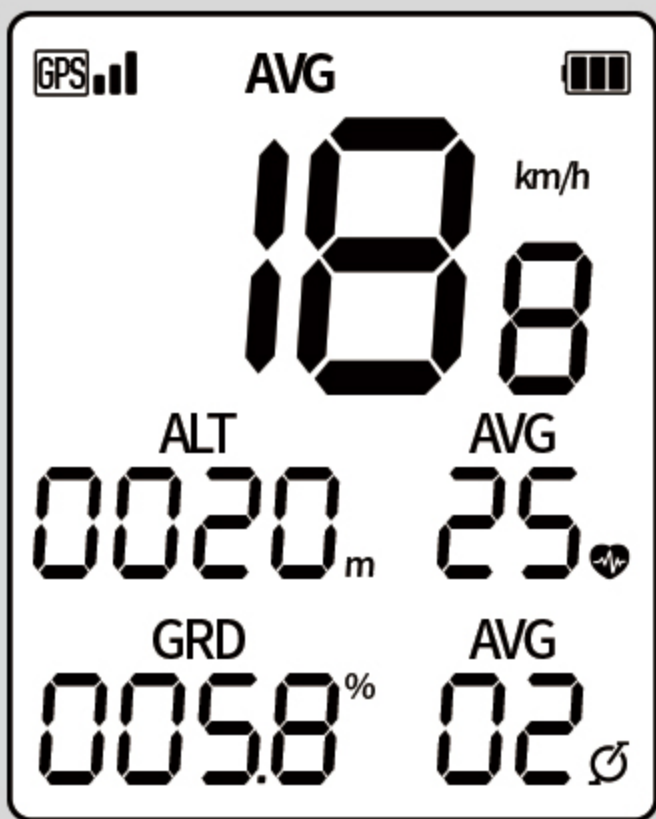
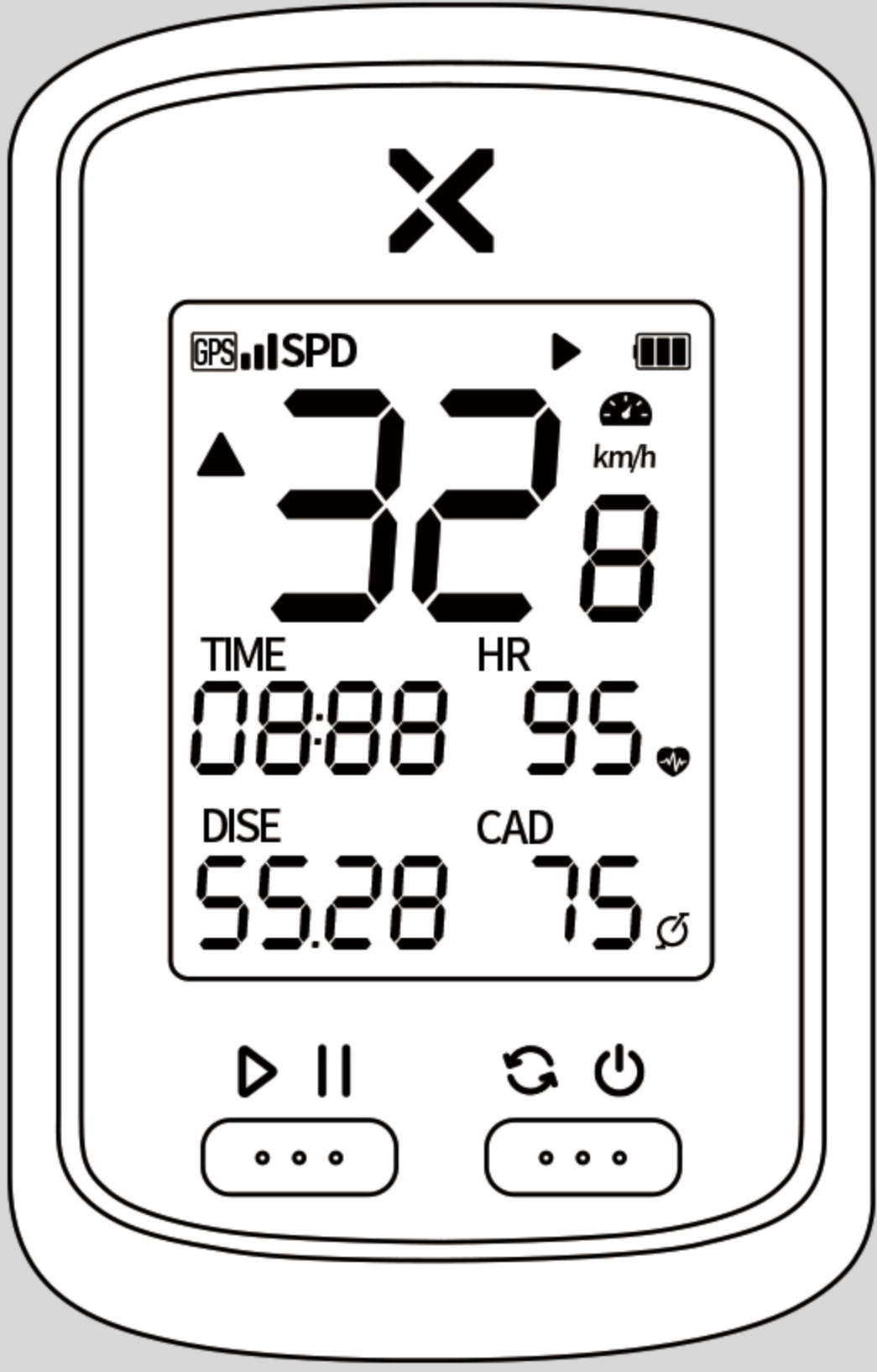
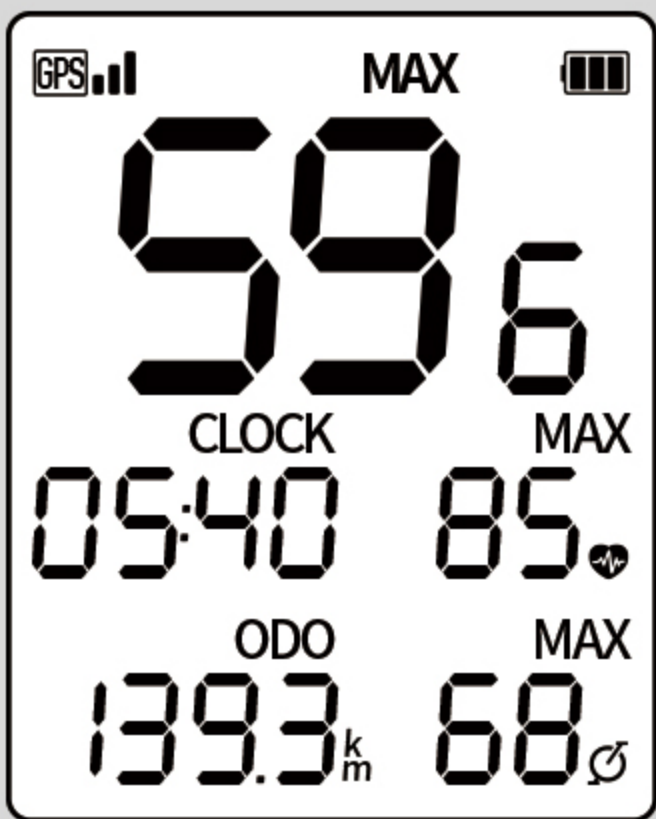

2.XOSS APP CONNECTION



Scan QR code to download XOSS,
or search XOSS in your APP store.

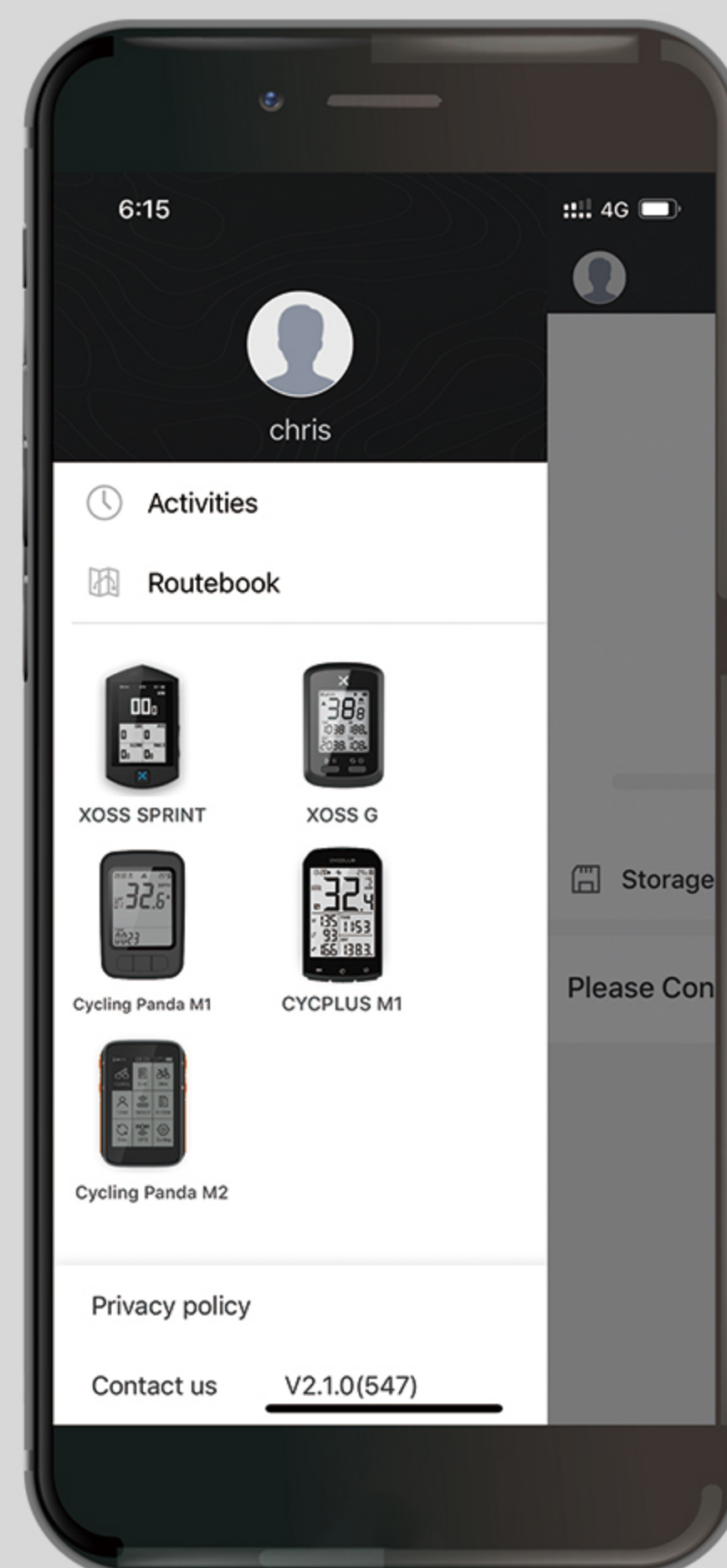
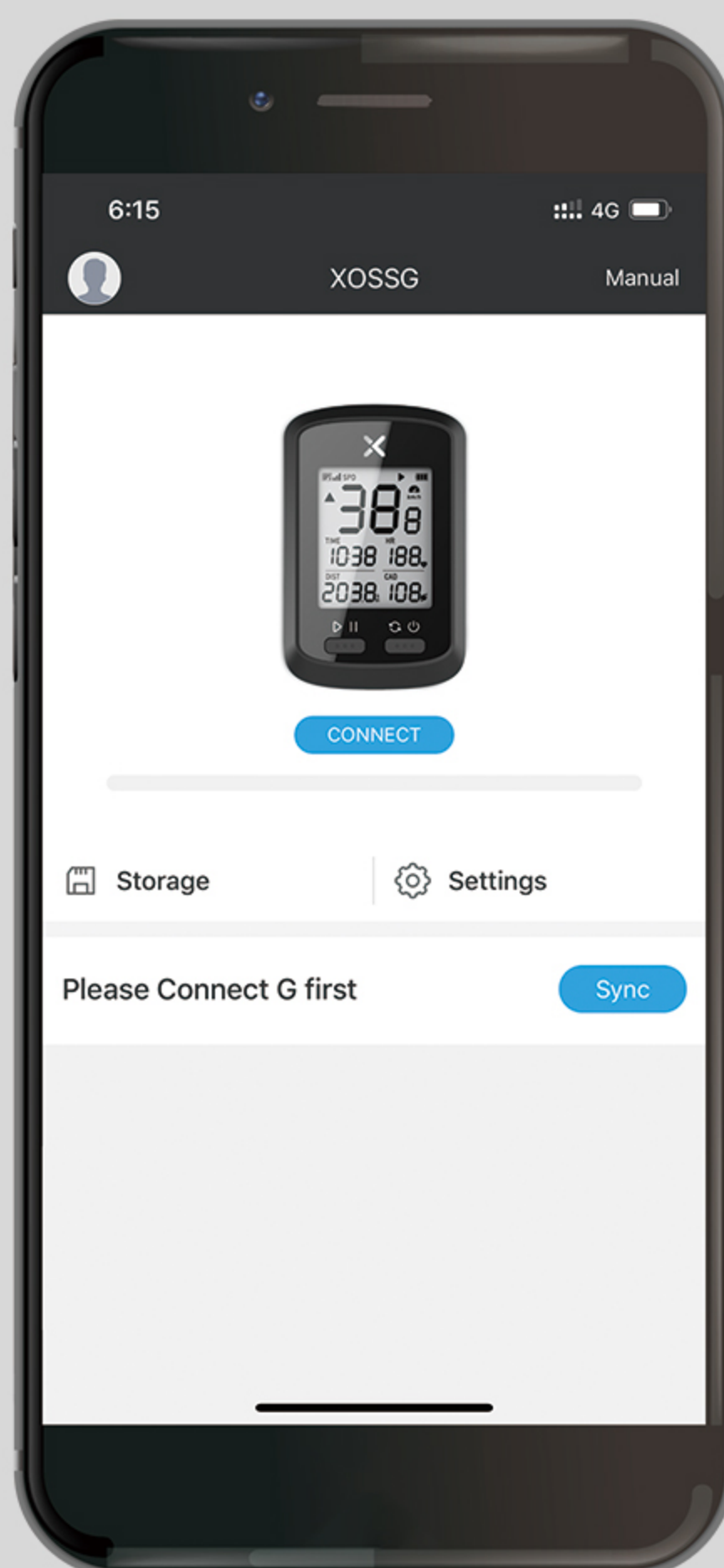

- Turn on XOSS G+ and turn on Bluetooth on the phone,
- Click on avatar and search for available devices.
- Select XOSS G+ for pairing.

The APP is designed for Bluetooth 4.0 and later versions.

3.XOSS APP SETTINGS

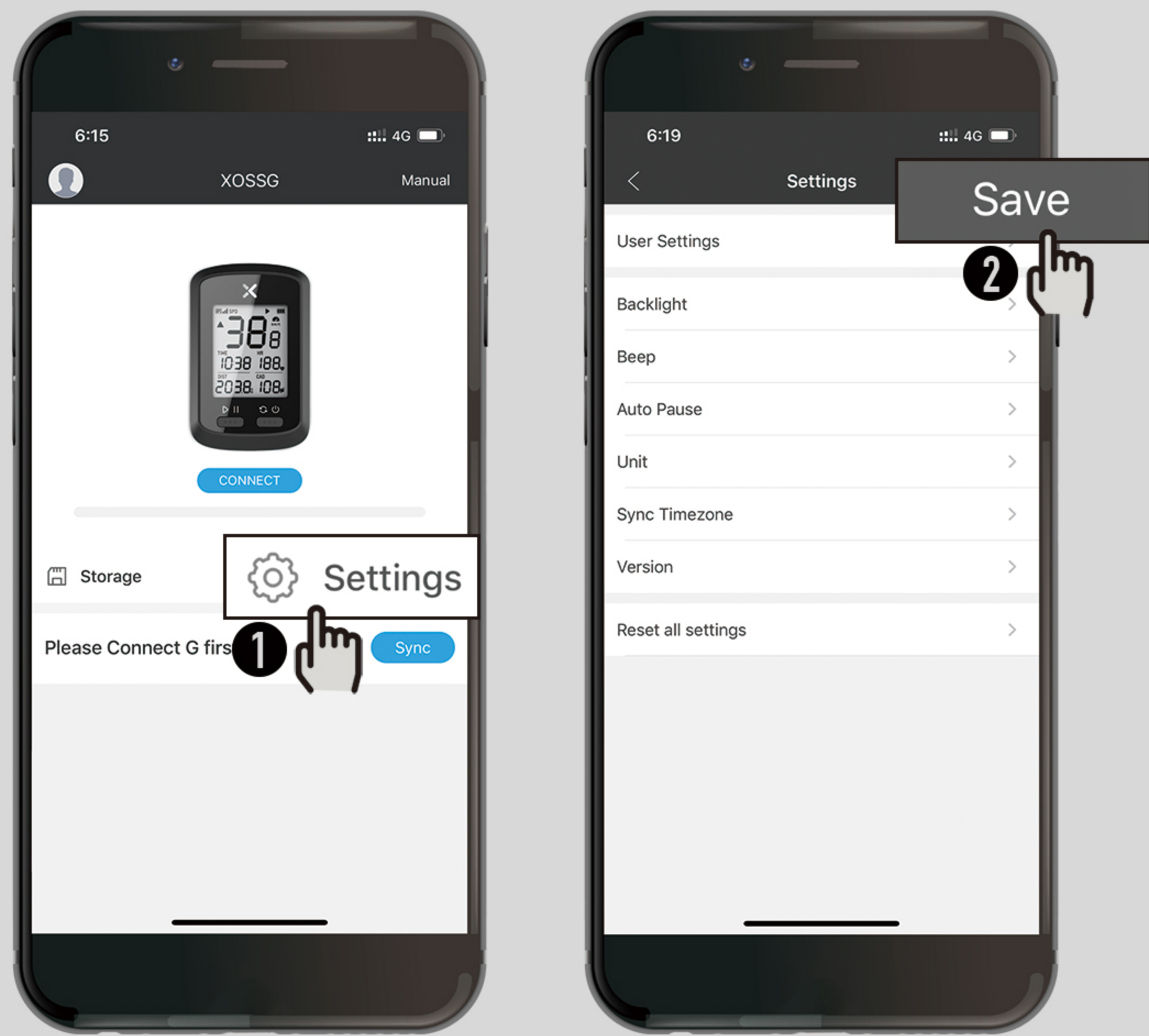

After connecting XOSS G+ with XOSS app, click settings to modify the features below.

- USER SETTINGS
- BACKLIGHT
- BEEP
- AUTO PAUSE
- UNIT
- SYNC TIMEZONE

Click **SAVE** after modification.

Note: RESET is used for restoring factory default setting, but not riding data.

SUPPORT

Speed Sensor

Heart Rate Monitor

Cadence Sensor

Speed/Cadence Sensor



1

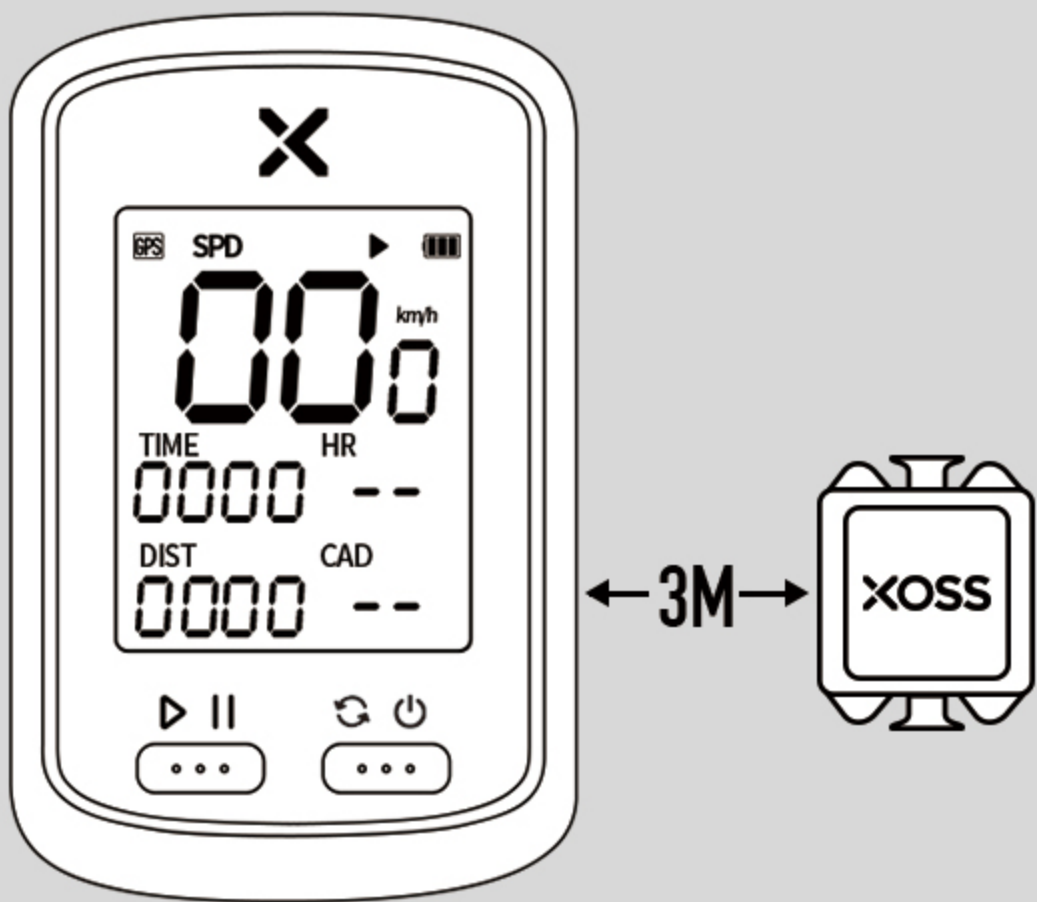

Bring the device within 3m of your sensors, and stay 10m far away from other rider’s sensors.

2

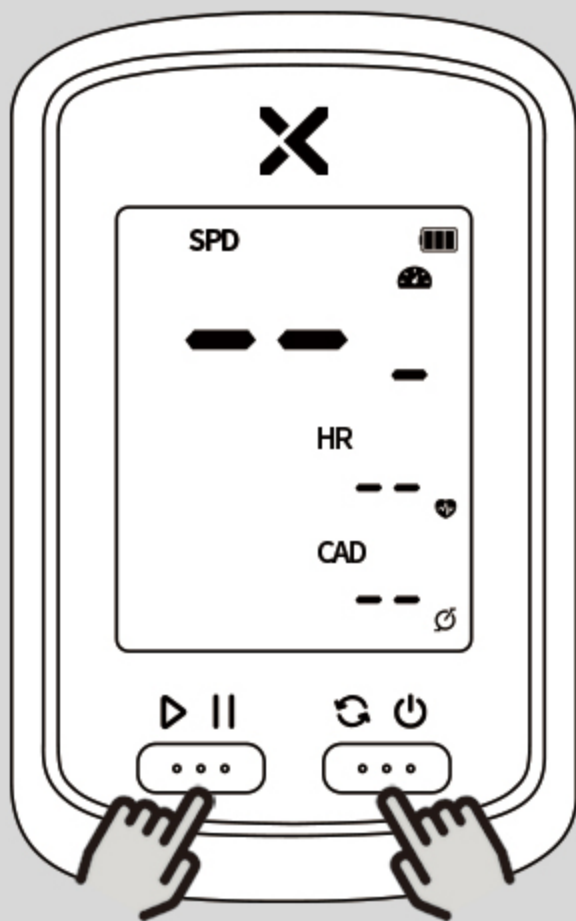

Press both buttons simultaneously on G+ until the icon is flashing, which indicates the XOSS G+ is searching active sensor nearby.

3

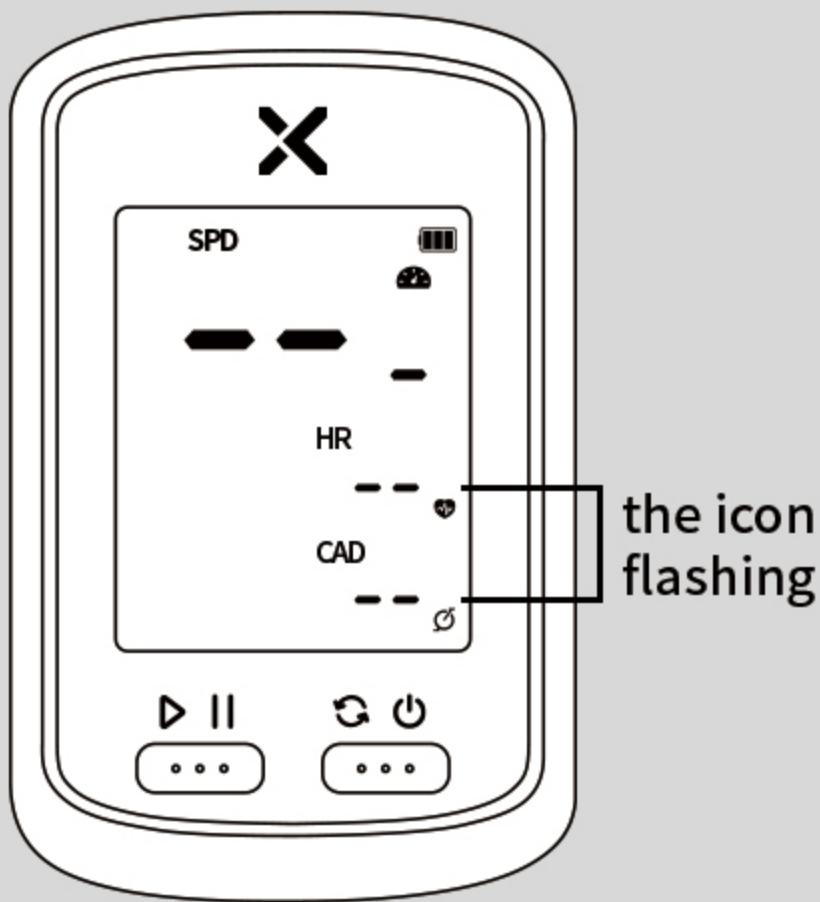

If the pairing succeeds, the icon will remain static, press the right button again, enter into settings interface.

[CIRCUMFERENCE] [METRIC/IMPERIAL] [TIME ZONE]SETTINGS

4

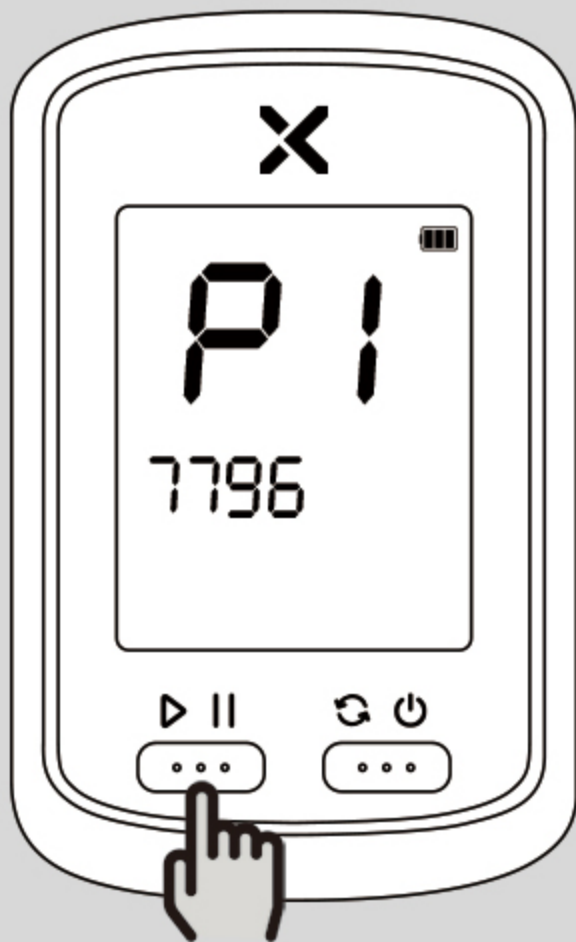

TIRE CIRCUMFERENCE
SETTING(MM)

Press the left button to set number or option.

5

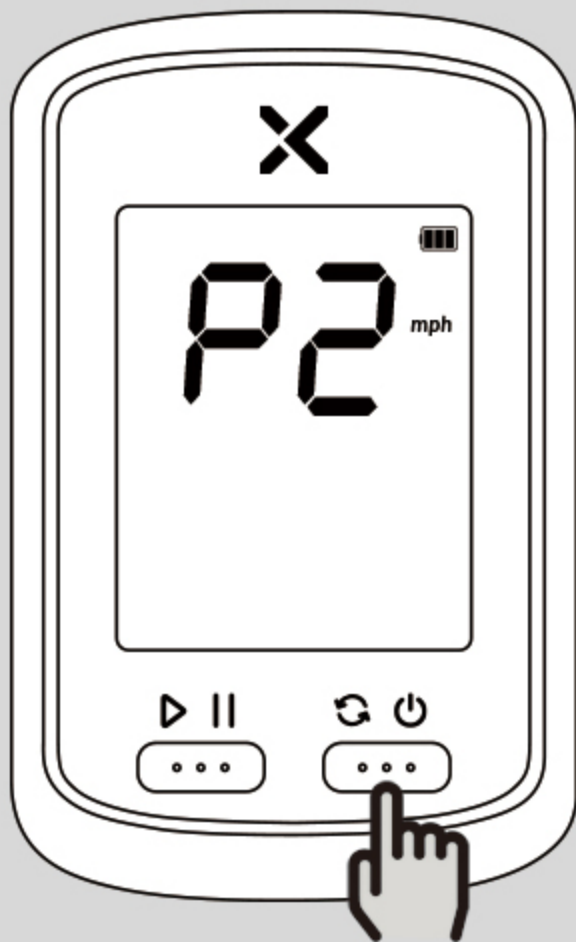

METRIC/IMPERIAL
UNIT SETTING

Press the right button to switch.

6

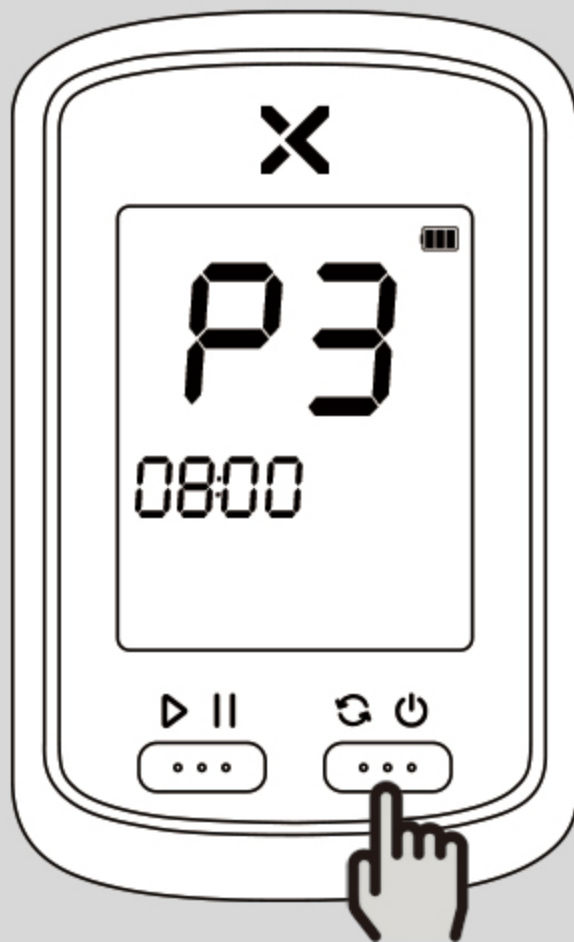

TIME ZONE SETTING

After setup, long press the right button to exit the settings.

5.SYNC TO STRAVA

Long press the left button to end your recording after every ride and sync your riding activities with the App

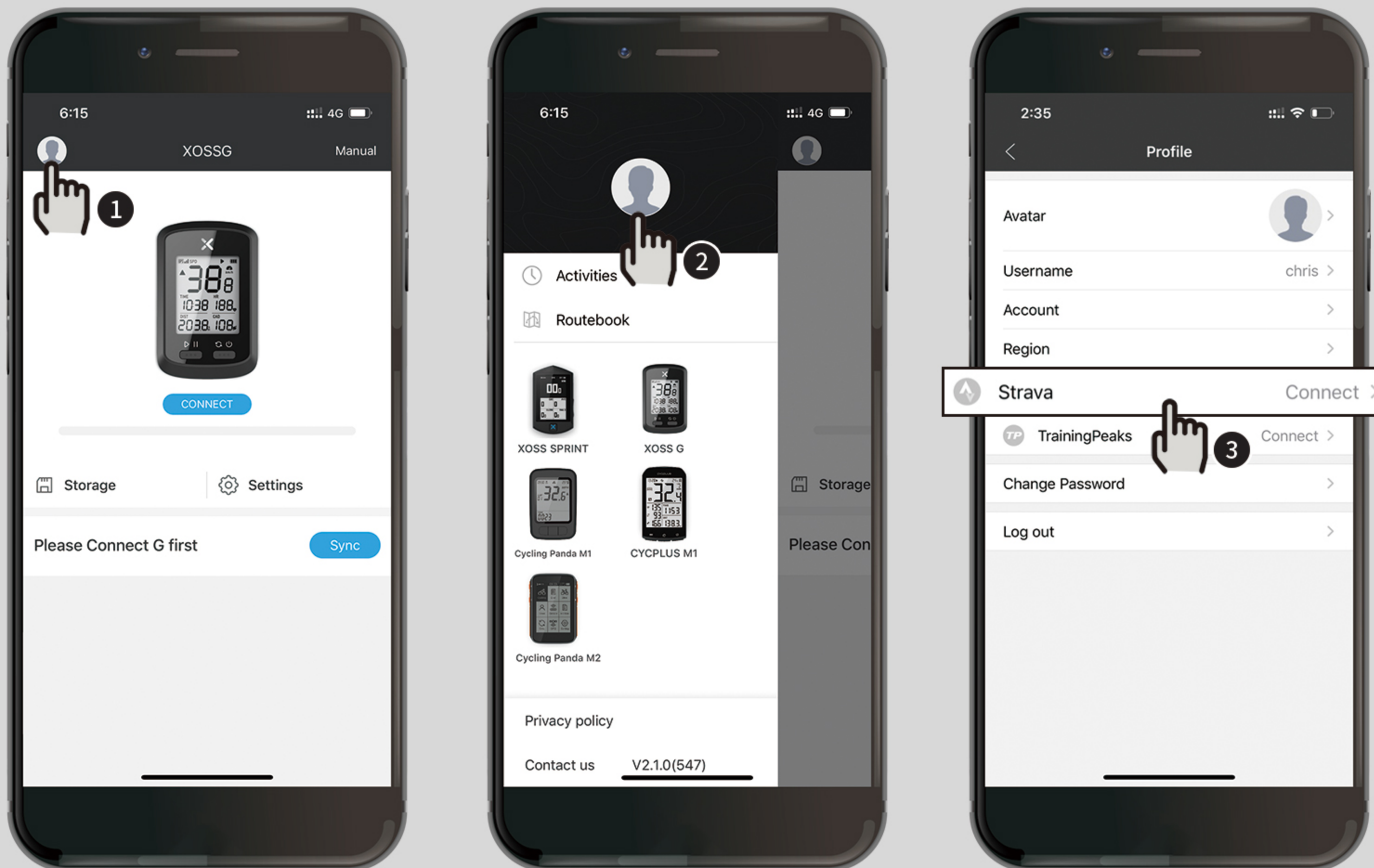

Click on avatar, enter into profile interface, sync your Strava account with XOSS. Please note, your riding activities only can sync to your Strava account after the connection succeeds.

6.UPGRADE FIRMWARE

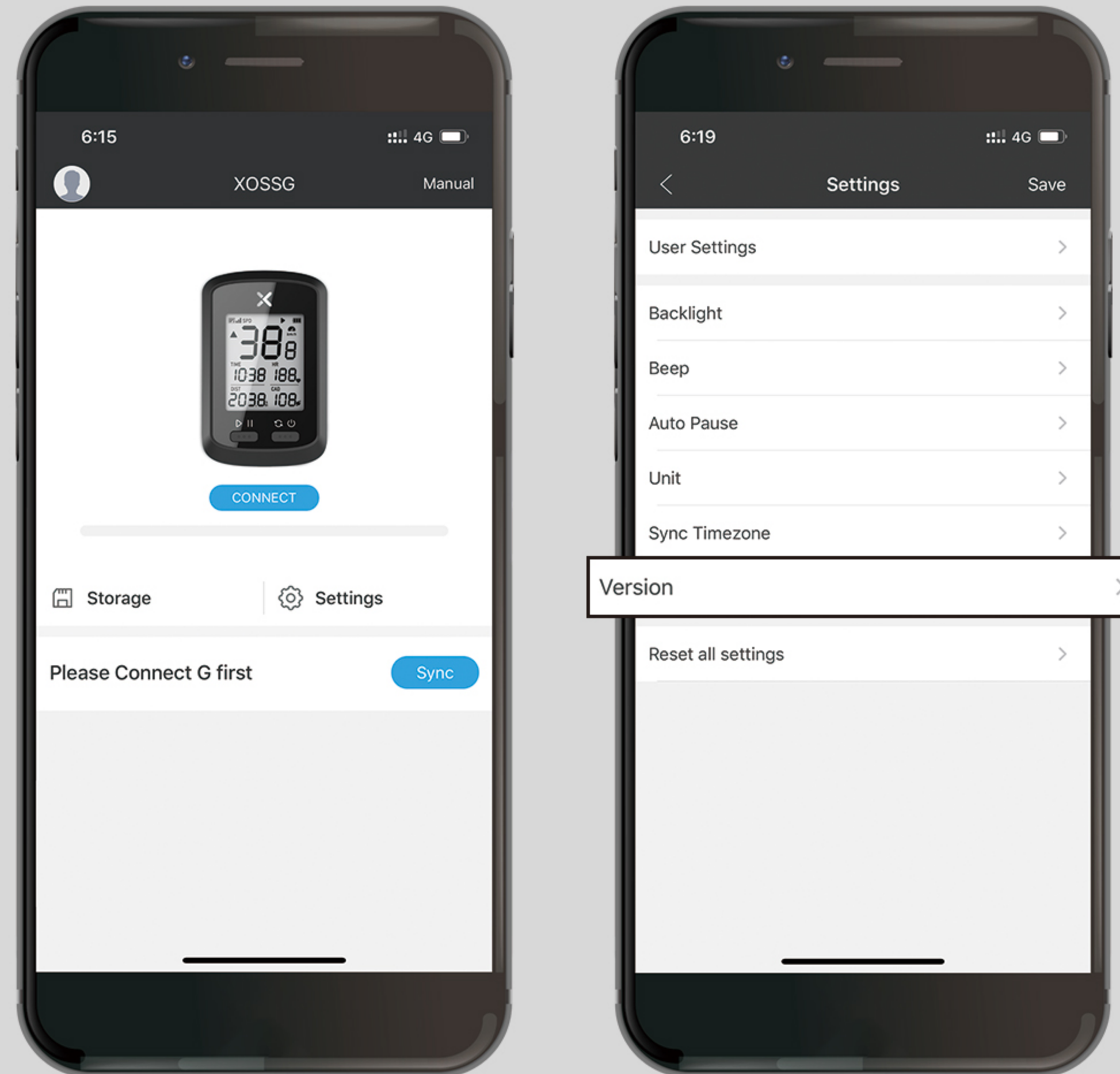

You are suggested to update the firmware from time to time.

Note:make sure your Bluetooth is on and XOSS G+ is turned on.

7.PACKING LIST



XOSS G+

GPS Cycling Computer*1

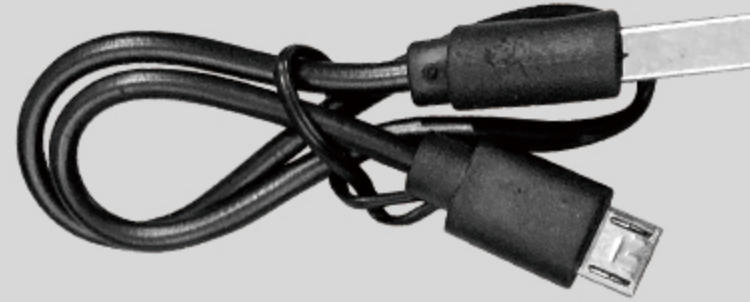

Micro USB Cable*1



Rubber Bands*2



Cycling Computer Mount*1

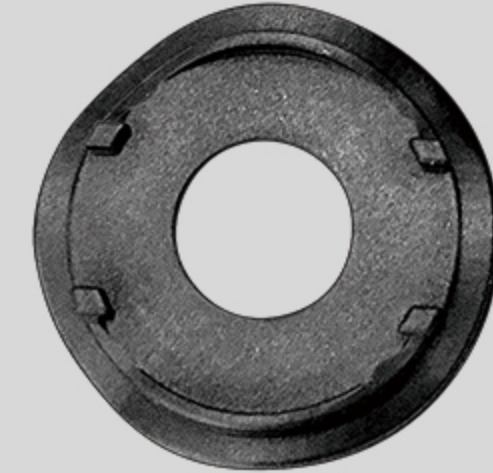

Protection Rubber Pad*1

WARRANTY

Thank you for purchasing our product. We offer a one-year manufacturer's warranty from the date of purchase. For details, please contact your retailer.

Our warranty does not apply to:

- a. Battery
- b. Misuse, abuse or damage caused by human factors
- c. Any unauthorized disassembly

XOSS HONG KONG CO., LIMITED

ROOMS 1318-9, HOLLYWOOD PLAZA, 610 NATHAN ROAD, MONGKOK, KL, HONG KONG

Any questions or more information, please contact us via support@xoss.co

Visit our website for more products xoss.co



FCC ID:2AJFWXOSSG